

2 Kensington Road, Chorlton, Manchester, M21 9QJ



JP&Brimelow
ESTATE AGENTS



3 1 3 D

VIDEO TOUR AVAILABLE A deceptively spacious and tastefully extended, period, THREE DOUBLE BEDROOM end of terraced property positioned off Manchester Road.

Located on a highly sought-after residential Road in Chorlton within easy walking distance to Chorlton centre, Longford Park, several local primary schools and a variety of shops, restaurants, cafes, and delis along Manchester Road.

The well-planned accommodation consists of a vestibule, entrance hall, a family room with bay window and a period fireplace with a decorative wooden surround. A lounge with an attractive period fireplace and access leading to a dining room. All three rooms benefit from stripped and varnished wooden floor boards. An inner hallway with useful storage and a door to the side leading out into the rear garden. To complete the ground floor there is a fitted kitchen to the rear with views into the courtyard style garden.

To the first floor there is a landing leading to three good-sized double bedrooms and an attractive white three-piece bathroom suite.

The property benefits from high ceilings, period features including ceiling coving, picture rails, cast-iron fireplaces, warmed by gas fired central heating. To the front aspect there is an enclosed garden and footpath leading to the front door. Whilst to the rear there is an enclosed courtyard style garden with decorative gravel area ideal for a table and chairs.

The property has easy access into Media City, the City Centre and Manchester International Airport, with the choice of two Metrolink stations, one on Ryebank Road, Firswood and the other on Wilbraham Road, Chorlton.

OFFERED WITH NO ONWARD CHAIN. Internal inspection is highly recommended.

£450,000





EPC Chart

Energy Efficiency Rating		
	Current	Potential
Very energy efficient - lower running costs		
(92 plus) A		
(81-91) B		
(69-80) C		77
(55-68) D	63	
(39-54) E		
(21-38) F		
(1-20) G		
Not energy efficient - higher running costs		
England & Wales	EU Directive 2002/91/EC 	



Tenure: Freehold Council Tax Band: B

Ground Floor

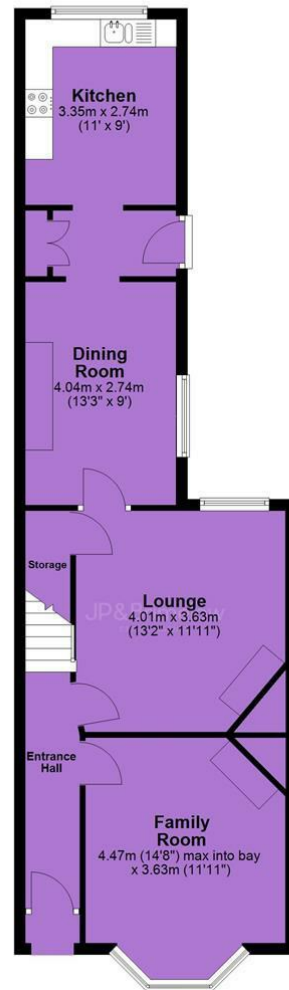

First Floor



JP & Brimelow Estate Agents Ltd
430 Barlow Moor Road, Manchester, M21 8AD
Tel: 0161 8822233
E: sales@jpbrimelow.co.uk www.jpandbrimelow.co.uk



JP & Brimelow
ESTATE AGENTS

NOTICE: JP & Brimelow Estate Agents Ltd for themselves and for the vendors or lessors of this property whose agents they are give notice that:

- (i) the particulars are set out as a general outline only for the guidance of intending purchasers or lessees, and do not constitute, nor constitute part of, an offer or contract;
- (ii) all descriptions, dimensions, references to the condition and necessary permissions for use and occupation, and other details are given in good faith and are believed to be correct but any intending purchasers or tenants should not rely on them as statements or representations of fact but must satisfy themselves by inspection or otherwise as to the correctness of each of them;
- (iii) no person in the employment of JP & Brimelow Estate Agents Ltd has any authority to make or give any representation or warranty whatever in relation to this property.

jpandbrimelowestateagents

@jpandbrimelow

